

Pin No.	Symbol	
	S-82J0A/B	S-82J0C/D
A1	VSS	VSS
A2	VDD	VDD
B1	TH	TH
B2	CO	CO
C1	TEST	PS
C2	DO	DO
D1	VINI	VINI
D2	VM	VM

No. HV008-A-P-SD-1.0

TITLE	WLP-8V-A-PKG Dimensions (S-82J0A/B/C/D*)
No.	HV008-A-P-SD-1.0
ANGLE	
UNIT	mm
<b>ABLIC Inc.</b>	

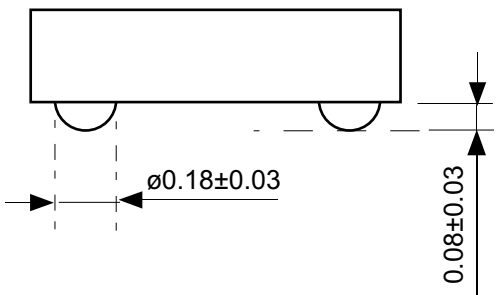
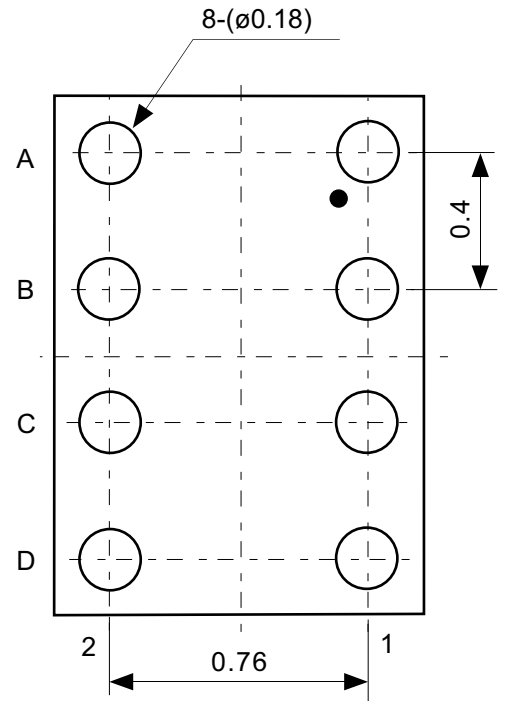
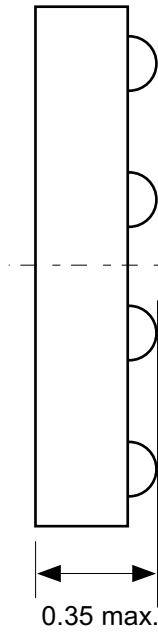
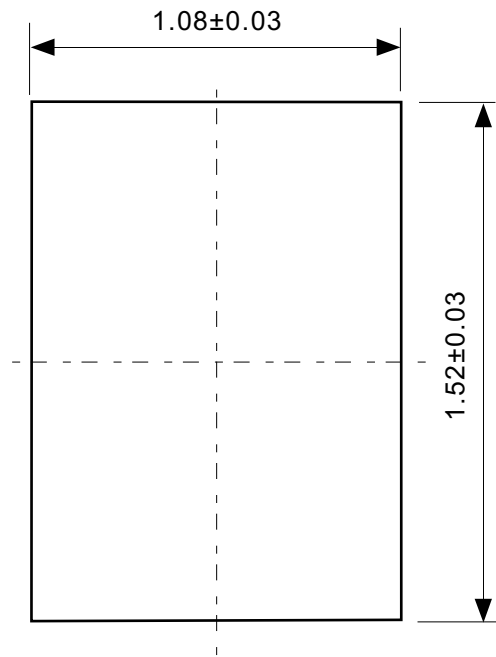

Pin No.	Symbol	
	S-82K0A/B	S-82K0C/D
A1	VSS	VSS
A2	VDD	VDD
B1	TH	TH
B2	CO	CO
C1	TEST	PS
C2	DO	DO
D1	VINI	VINI
D2	VM	VM

**No. HV008-A-P-S1-1.0**

TITLE	WLP-8V-A-PKG Dimensions (S-82K0A/B/C/D*)
No.	HV008-A-P-S1-1.0
ANGLE	
UNIT	mm
<b>ABLIC Inc.</b>	

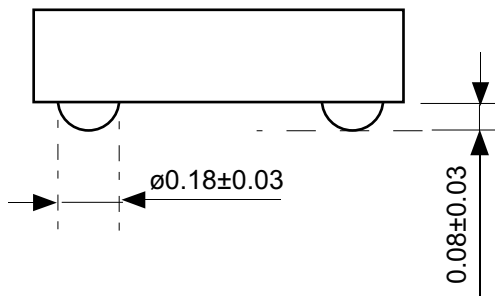
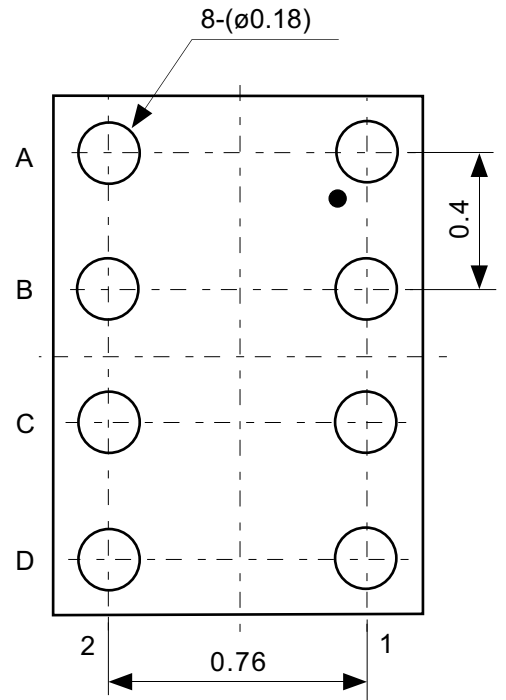
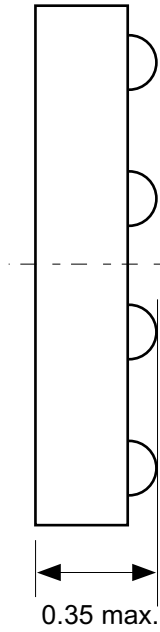
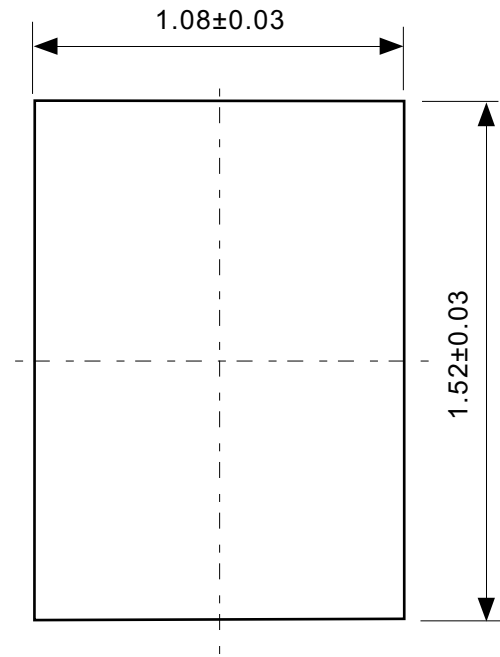

Pin No.	Symbol
A1	VSS
A2	VDD
B1	TH
B2	CO
C1	PS
C2	DO
D1	VINI
D2	VM

No. HV008-A-P-S2-1.0

TITLE	WLP-8V-A-PKG Dimensions (S-821A*,S-821B*)
No.	HV008-A-P-S2-1.0
ANGLE	
UNIT	mm
<b>ABLIC Inc.</b>	



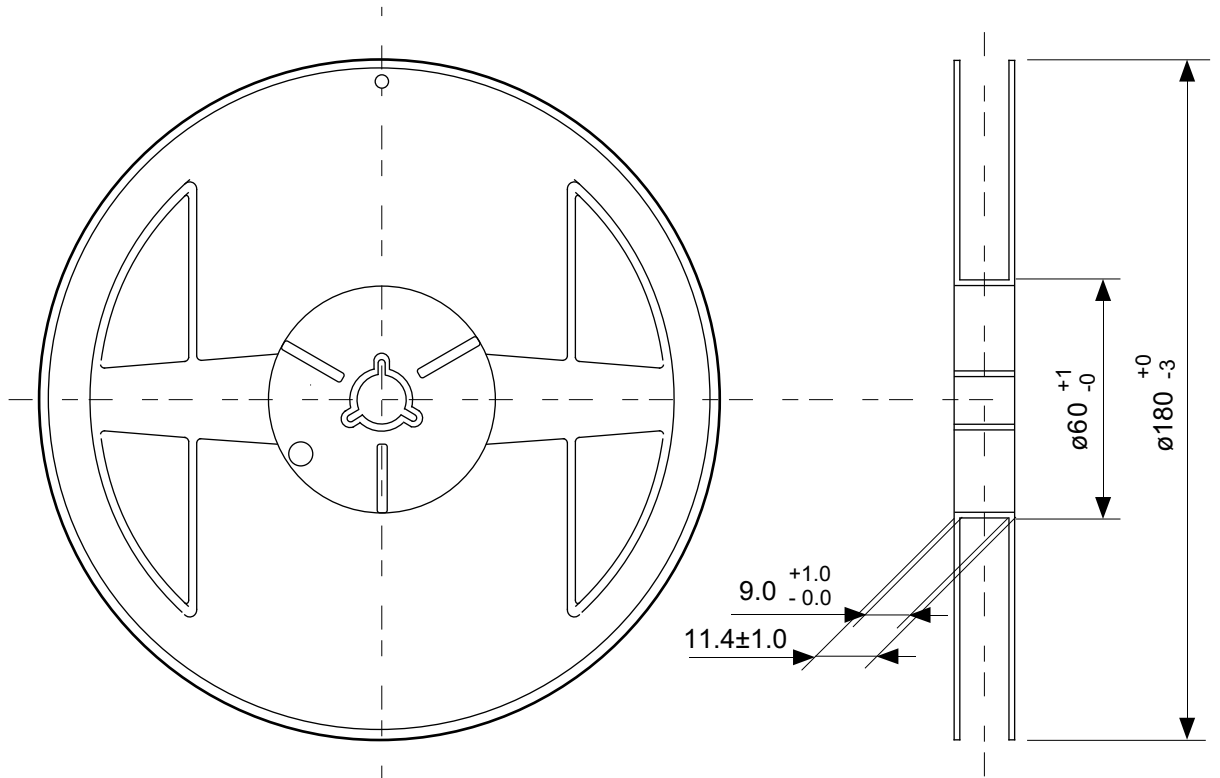

Enlarged drawing in the central part

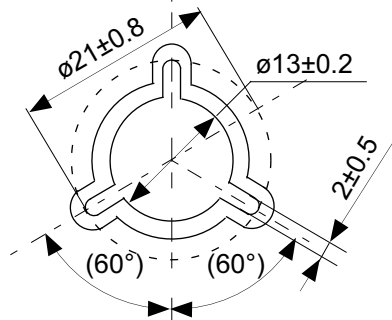

No. HV008-A-R-SD-1.0

TITLE	WLP-8V-A-Reel		
No.	HV008-A-R-SD-1.0		
ANGLE		QTY.	6,000
UNIT	mm		
<b>ABLIC Inc.</b>			

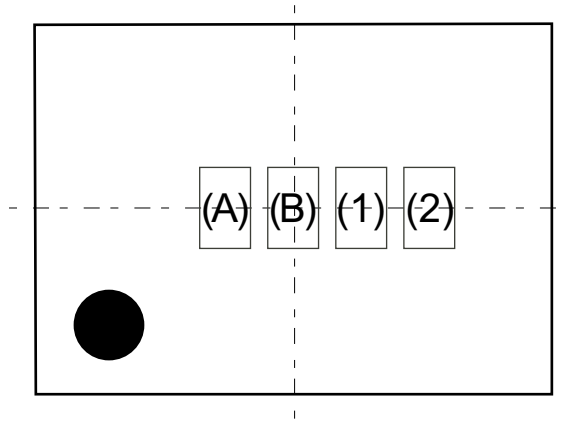

(A) , (B) : Product code

(1) , (2) : Lot code

● : 1 Pin mark

No. HV008-A-M-SD-1.0

TITLE	WLP-8V-A-Markings		
No.	HV008-A-M-SD-1.0		
ANGLE			
UNIT		TYPE	LASER
<b>ABLIC Inc.</b>			

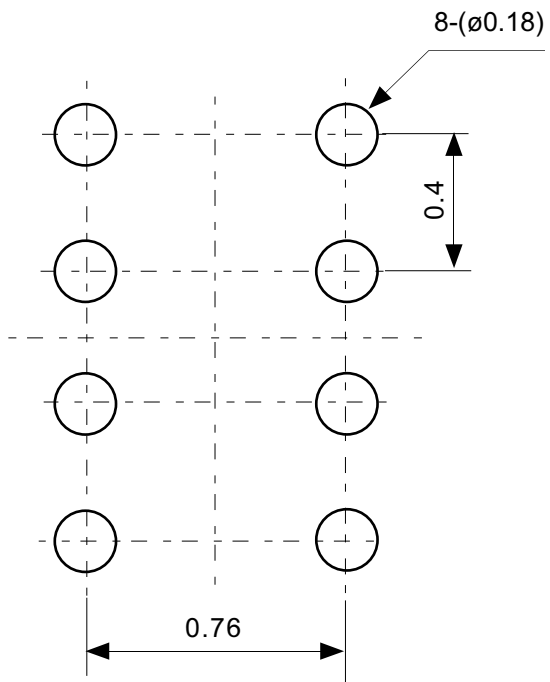

No. HV008-A-L-SD-1.0

TITLE	WLP-8V-A-Land Recommendation
No.	HV008-A-L-SD-1.0
ANGLE	
UNIT	mm
<b>ABLIC Inc.</b>	